

# Lenovo ThinkPad

Today's hybrid workforce that moves from home to office to everywhere in between, needs a portable, adaptable, and durable device. Lenovo ThinkPad X12 Detachable Gen 2 fulfills that need with a device that's more powerful than a tablet, but less cumbersome than a laptop. It combines the power, security, and durability you've come to expect from a ThinkPad with the portability, innovation, and sleek design of Lenovo's premium X Series.

For grab-and-go power, you'll love the 12-inch WUXGA display built on the Intel® vPro® platform for a world-class business PC solution. The Intel® Core™ Ultra processor delivers new AI experiences along with Intel® integrated graphics for immersive visuals. Video collaboration has never been better, as the integrated AI engine (NPU) with Windows 11 allows users to experience Windows Studio Effects, while Lenovo View further enhances video quality. Attach the folio keyboard with its distinct red TrackPoint, and you've got a lightweight, functional alternative to your business laptop.

Stay productive—and connected—on the road, at the coffee shop, and anywhere work happens with LTE 4G CAT16 capability. Rigorous in-house and MIL-SPEC 810H testing ensures this multi-functional masterpiece is durable enough for the manufacturing floor, in-field visits, and every harsh environment. And features like the fingerprint reader and IR camera with facial recognition enhance the end-to-end Lenovo ThinkShield security and robust Intel vPro® platform solutions.



Unlock new AI experiences

Smarter  
technology  
for all

Lenovo

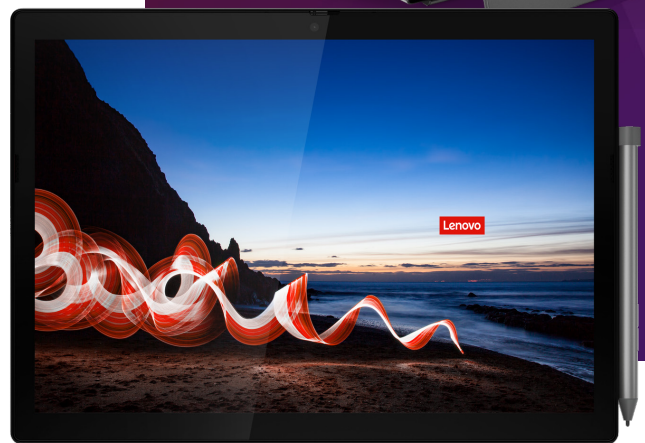

**Lenovo ThinkPad**  
X12 Detachable Gen 2

# Lenovo ThinkPad X12 Detachable Gen 2

## Committed to sustainability

At Lenovo, we're focused on providing smarter technology that builds a brighter, more sustainable future for our customers, colleagues, communities, and the planet. We're determined to build a smarter future for all through the products and services we offer. And we partner with Intel, the industry leader in sustainable semiconductor manufacturing.

As we continue innovating to provide technology solutions that are more energy efficient and human-centered like the Lenovo ThinkPad X12 Detachable, we stay focused on empowering you to meet your own sustainability goals—and solve humanity's greatest challenges.



REDUCING GREENHOUSE GAS EMISSIONS



PACKAGING SUSTAINABILITY



SUSTAINABLE PRODUCT DESIGN



SUPPLY CHAIN SUSTAINABILITY



## certifications & registries

ENERGY STAR® 8.0 certified

EPEAT® Gold registered in U.S., Canada, and Germany

TCO 9.0 Certified

### Responsible design

### Lenovo ThinkPad X12 Detachable

A Cover	90% recycled magnesium
C Cover	30% PCC recycled plastic
D Cover	30% PCC recycled plastic
Speaker Enclosure	30% PCC recycled plastic
Kickstand	50% recycled aluminium
Battery	25% PCC recycled plastic used in the 42Whr battery enclosure
AC Adaptor	Up to 90% PCC recycled plastic used in standard 45W and 65W USB-C, and Slim 65W adaptors
Packaging	FSC-certified with 85% recycled plastic and/or sustainable content <sup>1</sup>
TOTAL PCC	27.9% by weight

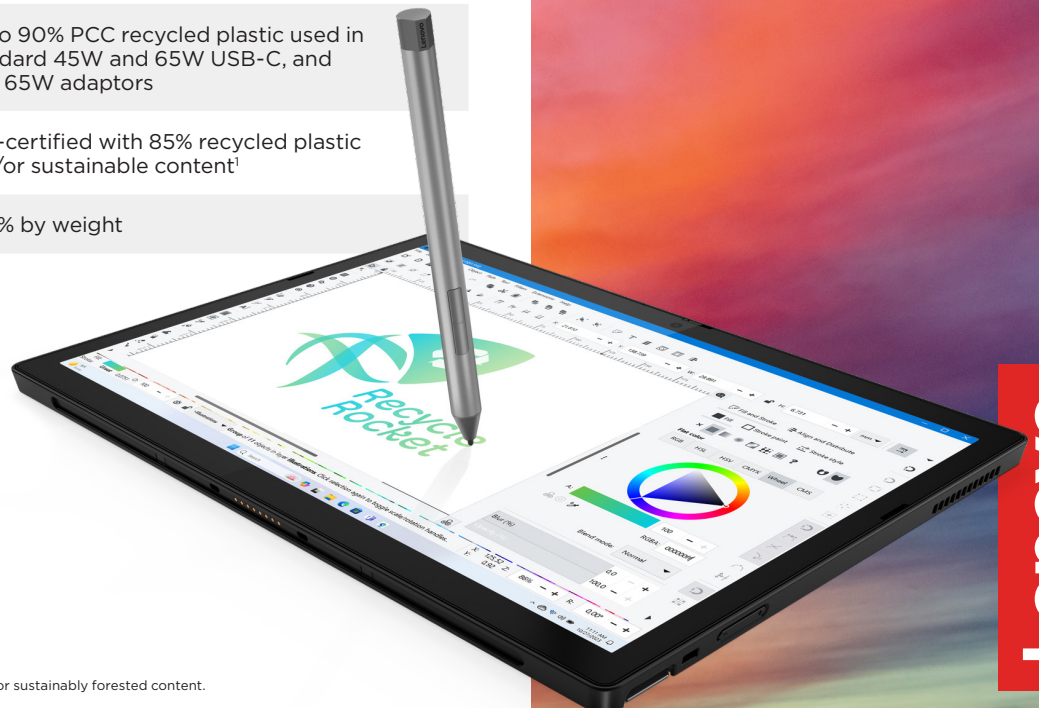

<sup>1</sup>Packaging composed of recycled, and/or biobased, and/or sustainably forested content.

Lenovo

# Lenovo ThinkPad X12 Detachable Gen 2 EMEA version April 2024

## performance

### PROCESSOR

Intel® vPro® with Intel® Core™ Ultra processor U series

### OPERATING SYSTEM

Windows 11 Pro

### GRAPHICS

Intel® integrated graphics

### CAMERA

8MP World Facing Camera  
5MP + IR with webcam privacy shutter

### MEMORY

Up to 32GB 6400MHZ LPDDR5X

### STORAGE

Up to 1TB PCIe Gen4x4 SSD (2242)

### BATTERY

42Whr

### AC ADAPTOR

Up to Type-C 65W (supports Rapid Charge)

### AUDIO

Dolby® Audio  
Dolby® Voice  
2 speakers, 2 mics (30% PCC recycled plastic)

## connectivity

### INPUT/OUTPUT PORTS

1x USB-C (Thunderbolt 4/USB4 40Gbps), with Power Delivery 3.0 and DisplayPort 2.1  
1x USB-C 10Gps (USB-C 3.2 Gen 2), with Power Delivery 3.0 and DisplayPort 2.1  
1x NanoSIM  
1x Audio (Headphone and Microphone Combo Jack)

### WIRELESS

Wi-Fi 6E  
4G LTE CAT16 WWAN (Optional)  
Bluetooth 5.3

### NFC

Yes (optional)

### DOCKING

Thunderbolt 4 Dock  
USB Type-C Dock

## design

### DISPLAY

12.3" WUXGA (1920x1280) Low-power IPS OGS Touch ARAS (400nits, 100% sRGB)

### DIMENSIONS (W X D X H)

283.3 x 203.5 x 8.8 mm (14.5 mm with keyboard)  
11.15 x 8.01 x 0.22 in (0.34 with keyboard)

### WEIGHT

0.76kg/1.67 lbs (Tablet)  
0.34kg/0.75 lbs (Folio Keyboard)

### MIL-STD 810H

Yes

### KEYBOARD

Backlit, detachable folio keyboard with fingerprint reader and touchpad  
ThinkPad TrackPoint keyboard

### PEN

Lenovo Precision Pen (Optional)

### COLORS

Thunder Black

## software

### LENOVO VALUE-ADD PRELOADED APPS

Lenovo Commercial Vantage  
Lenovo View  
Lenovo Pen Settings  
Intel Connectivity Performance Suite

## security

Intel vPro® Platform  
Touch Fingerprint Reader  
IR camera with webcam privacy shutter  
Discrete Trusted Platform Module (dTPM) 2.0  
Kensington Nano Security Slot™



## Unlock new AI experiences

©2024 Lenovo. All rights reserved. These products are available while supplies last. Prices shown are subject to change without notice. For any questions concerning price, please contact your Lenovo Account Executive. Lenovo is not responsible for photographic or typographic errors. Warranty: For a copy of applicable warranties, write to: Warranty Information, 500 Park Offices Drive, RTP, NC 27709, Attn: Dept. ZPYA/B600. Lenovo makes no representation or warranty regarding third-party products or services. Trademarks: Lenovo, the Lenovo logo, Rescue and Recovery, ThinkPad, ThinkCentre, ThinkStation, ThinkVantage, and ThinkVision are trademarks or registered trademarks of Lenovo. Microsoft, Windows, and Vista are registered trademarks of Microsoft Corporation. Intel, the Intel logo, Intel Inside, Intel Core, and Core Inside are trademarks of Intel Corporation in the U.S. and/or other countries. Other company, product and service names may be trademarks or service marks of others.

Lenovo